



Installation Instructions

Shutter Guardian *Storm panel security locking solution*

Read this first

***Congratulations on your purchase!
The info you need to get started is included in the instructions.***

Before beginning installation, carefully read these instructions. This will simplify the installation and ensure the Shutter Guardian system is installed correctly and safely. When installing storm panels always wear protective clothing, eyewear and gloves. Carefully follow storm panel manufactures instructions.

Thank you for making Shutter Guardian a part of your homes security.

If you have any problems, a representative can help you get the most from your new product by explaining any questions you may have.

***Visit our Website sutterguardian.com
email - Support@shutterguardian.biz
1-855- HIWINDS 1-855-449-4637***

Do not return this product to the store.

PARTS LIST	3
PARTS DESCRIPTIONS & USE	4
TYPES of TRACKS & MOUNTING SYSTEMS	5
TYPES of STORM PANELS.....	6

INSTALLING

END BRACKET INSTALLATION on DIFFERENT TYPES of MOUNTING SYSTEMS

END BRACKETS on F - TRACK	7
END BRACKETS on STUDDED L TRACK	8
END BRACKETS on DIRECT MOUNT with PANEL STUDS	9
END BRACKETS on DIRECT MOUNT with SIDEWALK BOLTS	10

DIFFERENT TYPES of STORM PANELS

BASIC INSTALLATION CORRUGATED PANELS	11
INSTALLATION FLAT PANELS	9...10

ADDING PANEL BRACES & GUARDS

PANEL V GUARDS	12
CENTER PANEL L BRACE & CENTER PANEL L GUARD.....	13
USING the COMBINATION EXTENSION BAR BRACE & GUARD	14

USING EXTENSIONS

ADDING EXTENSIONS with COUPLINGS	15
--	----

LOCKING

HOW to LOCK at EITHER END	16
---------------------------------	----

Parts List

Page 3

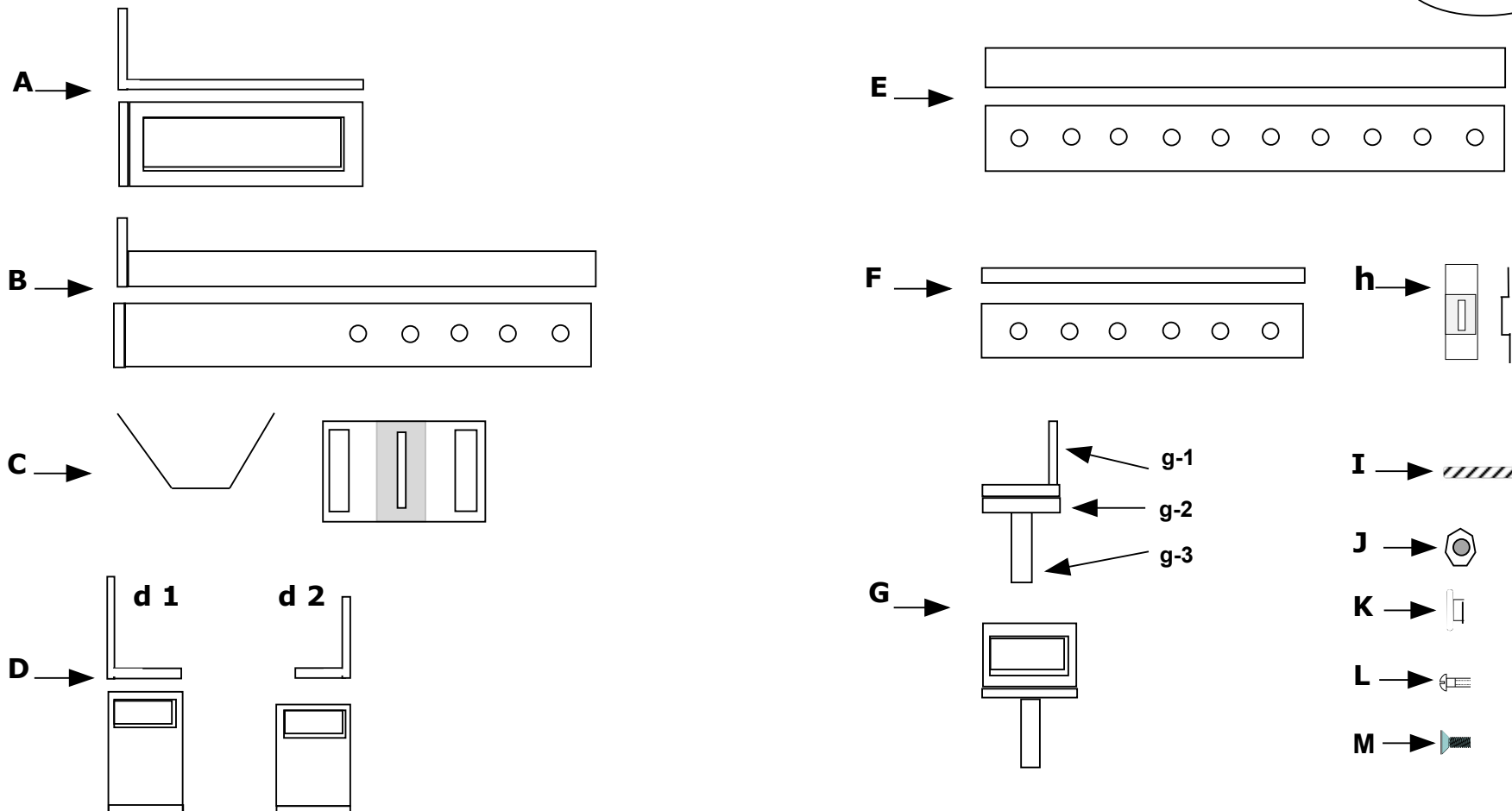

SHUTTER GUARDIAN

A - End Bracket
B - Lock Bar
C - V Guard
D - Bar Support
d - 1 L Brace
d - 2 L Guard
E - Extension Bar

F - Extension Bar
Coupling
G - Bar Support
g - 1 Guard
g - 2 Guard Brace
g - 3 Post Bracket
H - Keeper

I - All Thread
J - Hex Jam Nut
K - Captive Nut
L - Socket Cap Bolt
M - Socket Bevel Bolt

TOOLS NEEDED

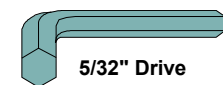

5/32" Drive

Allen
wrench

Parts Descriptions & Use

Page 4

A- End Bracket - The main component, installs under storm panels.
Holds both Lock Bars & Extension Bars in place over panels.

B- Lock Bar - Starting bar. Hooks & slides through End Brackets. Locks at either end.
Joins with Extension Bars to increase lengths.

C- Panel V Guard - Slides onto Lock & Extension Bars,
covers End Bracket mounting bolt fasteners.

D- Center Panel L Brace & Center Panel L Guard

d-1 L Brace - Strengthens center spans of Lock & Extension Bars. Mounts on top of panels.
Used under Center Panel Guard.

d-2 L Guard - Slides onto Lock & Extension Bars.
Covers Center Panel Brace mounting fasteners.

E- Extension Bar - Adds length to Lock Bars & other Extension Bars.
Used to span large openings.

F- Extension Bar Coupling - A brace placed behind two bars.
Used to join Lock Bar to Extension Bar or two Extension Bars together.

G- Extension Bar Brace & Center Panel Guard - A 3 piece panel guard used in large
expansions of panels where sliding the bars is limited.

H- Keeper - Holds End Bracket to mounting system.

I- All thread - Used to replace side walk bolts in direct mount systems, flat panel
systems using anchors & side walk bolts.

J- Hex Jam nut - Fastens to mounting bolt to hold Keepers in place.

K- Captive nut - Used along with Socket Beveled Bolt to secure coupling to
Lock & Extension Bars.

L- Allen Cap Bolt - Fastener that bolts Panel Guard to platform when using the Bar Brace
& Panel Guard (G).

Types of tracks & mounting systems

Page 5

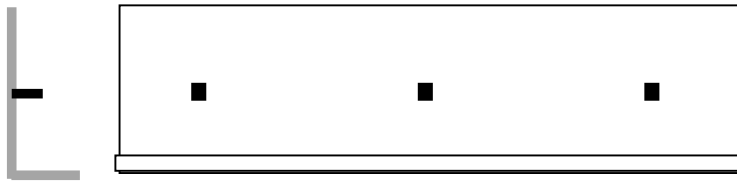

Studded L Track

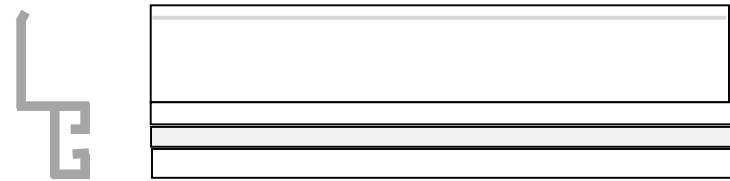

Extended track

Non extended track

F - Track - Slide bolts

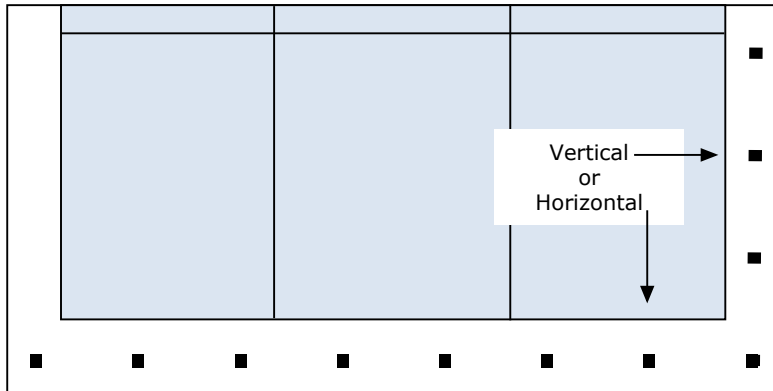

Direct Mount - Panel studs

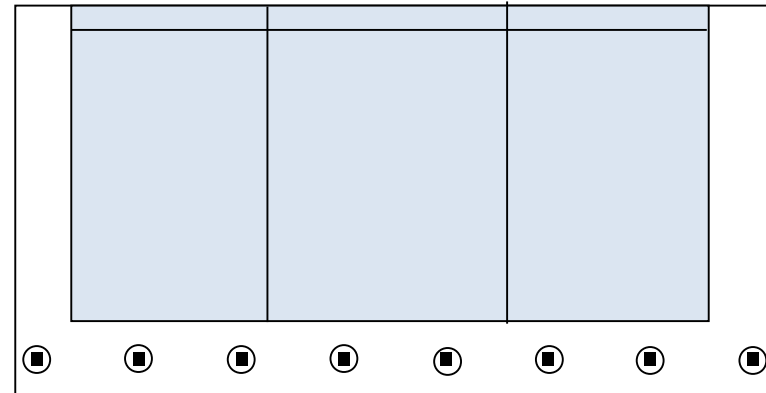

Direct Mount - Sidewalk Screws & Bolt anchors

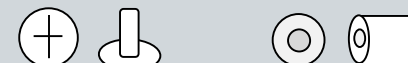

Types of Storm Panels

Page 6

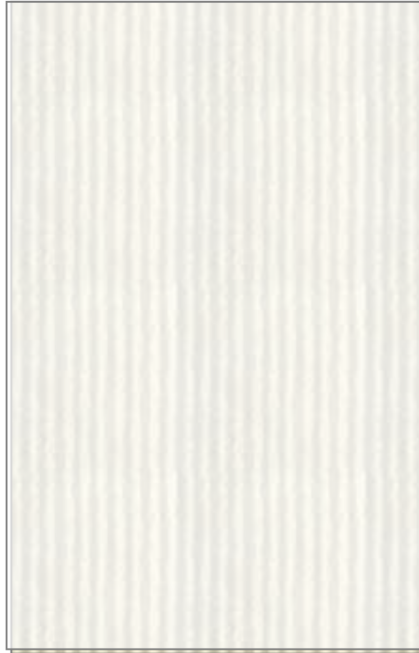
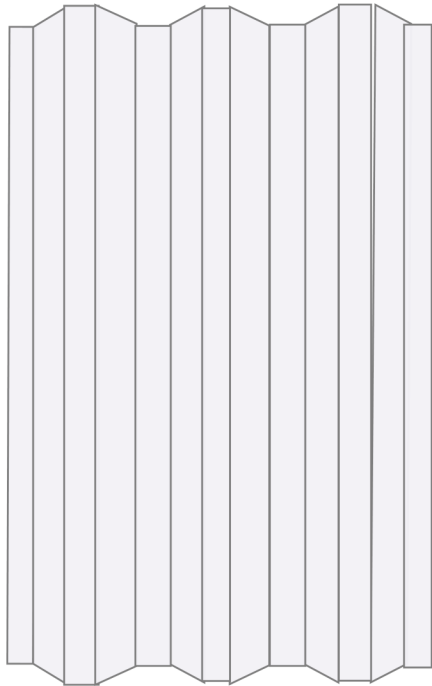

Corrugated

Steel
Aluminum
Polycarbonate

Flat panels

Polycarbonate

Plywood

End Bracket on F-Track mounting system

Page 7

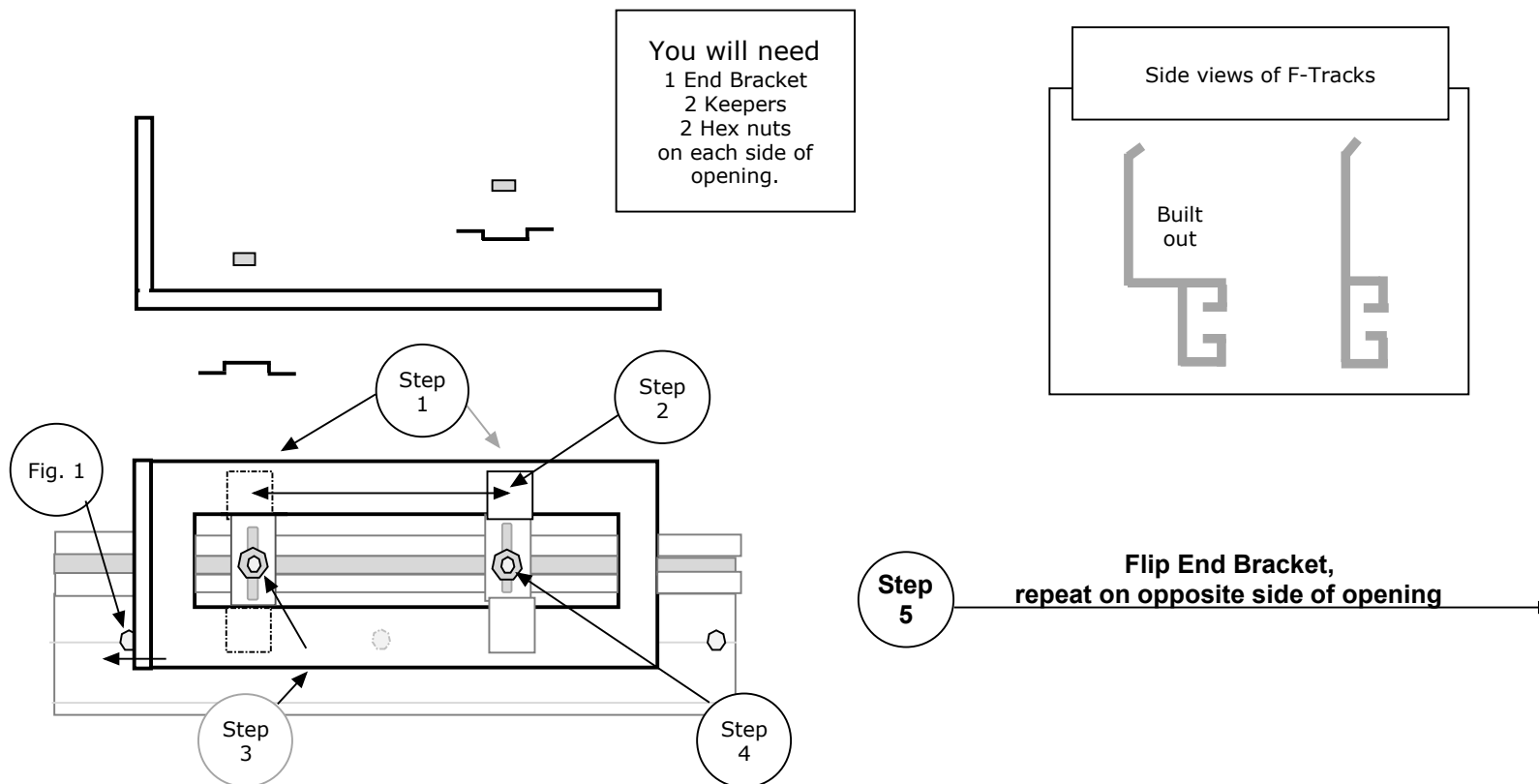

How to install End Brackets & Keepers to F - Track mounting systems

1. Place both Keepers in opening of End Bracket, one on the back facing up the other on the front facing down.
2. Slide Keepers to the spacing required for your panels.
3. Mount End Brackets with Keepers onto the F-Track slide bolts closest to edges of opening.
If F-Track is installed as shown make sure the End Brackets cover panel track mounting bolts. See Fig. 1
4. Fasten Hex nuts onto sliding panel mounting bolts, lightly hand tighten allowing for adjustment.
5. Repeat on opposite side of opening.

Continue following basic installation, installing storm panels as recommended by manufacturer covering both End Brackets.

Studded L Track mounting system

Page 8

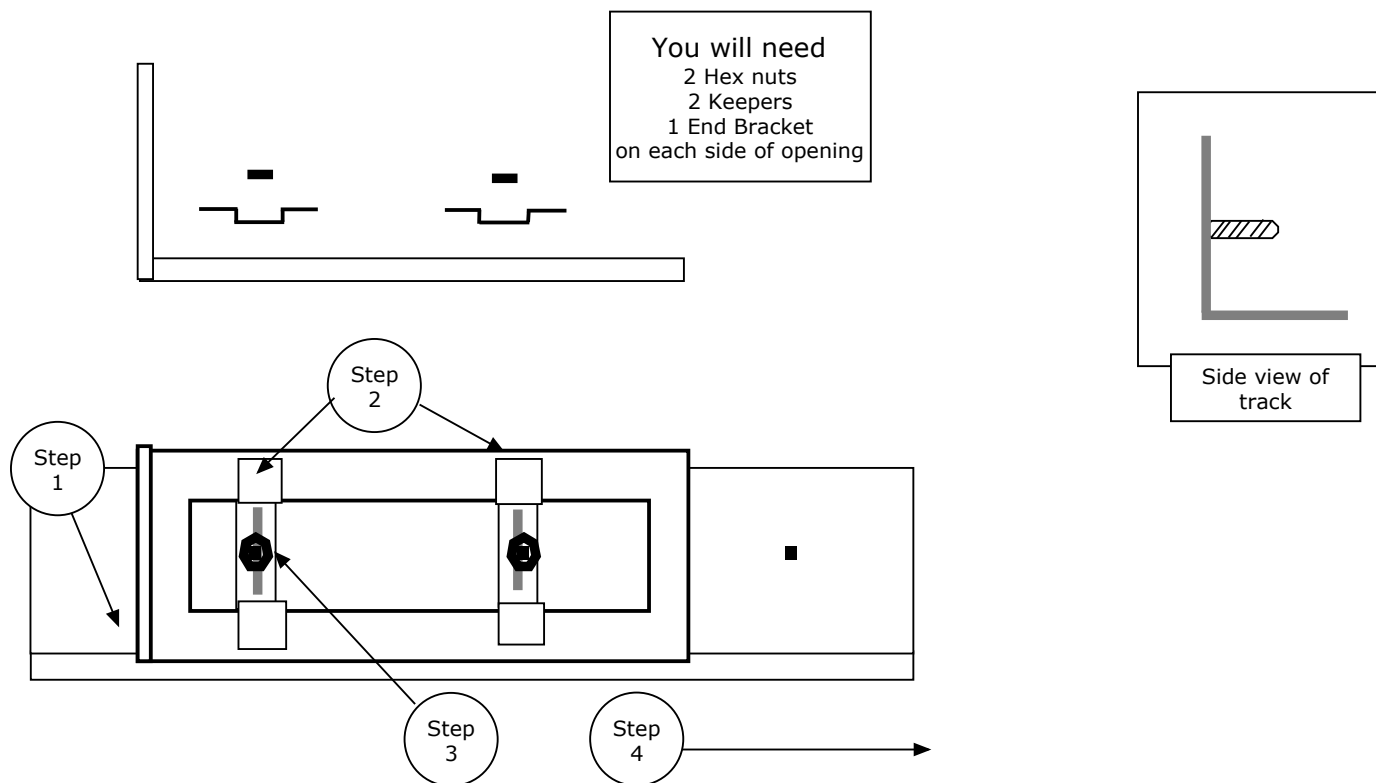

How to install End Brackets to Studded L Track mounting systems

1. Set End Bracket on ledge of track positioning opening over first two mounting bolts closest to edge of opening.
2. Apply Keepers over End Bracket opening, aligning with mounting stud bolts.
3. Lightly hand tighten hex nuts to mounting bolts.
4. Repeat on opposite side of opening.

Continue with basic installation,
installing your storm panels as recommended by manufacturer covering both End Brackets.

Direct Mount - Panel studs

Page 9

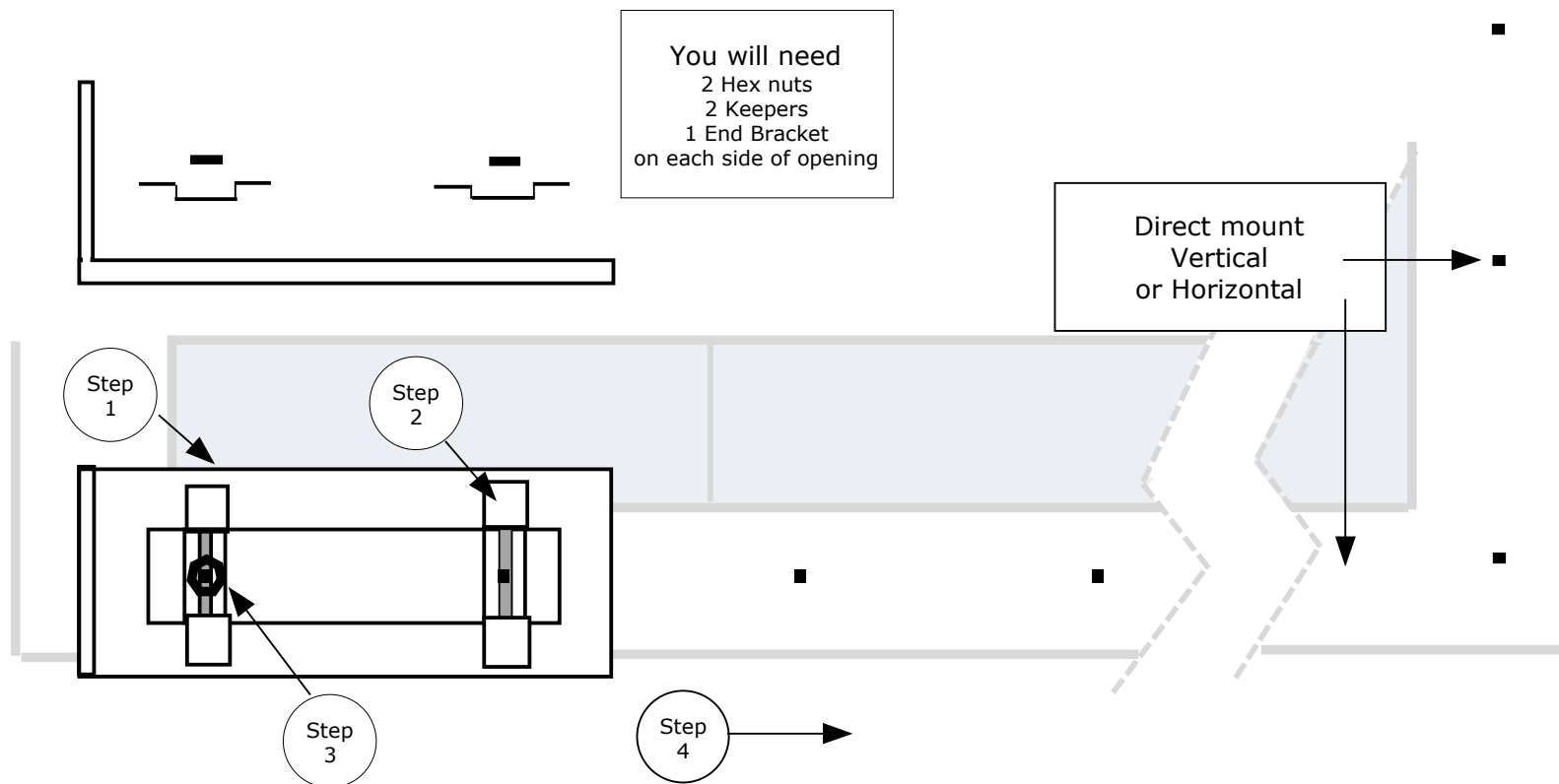

How to install End Brackets & Keepers to Direct Mount mounting systems with Panel stud fasteners

Direct Mounting systems can be vertical or horizontality mounted

1. Hold End Bracket over first two panel studs closest to edge of opening.
2. Add Keepers on top of End Bracket opening aligning with mounting bolts.
3. Lightly hand tighten Hex nuts.
4. Repeat on opposite side of opening.

Continue with basic installation, installing storm panels as recommended by manufacturer covering both End Brackets.

Direct Mount - Sidewalk bolts

Page 10

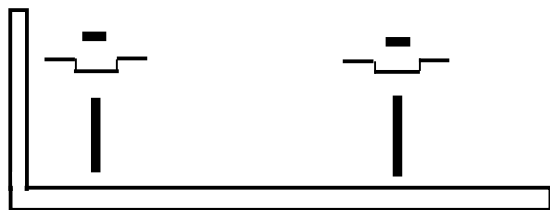

You will need
2 Hex nuts
2 Keepers
2 All threads
1 End Bracket
on each side of opening

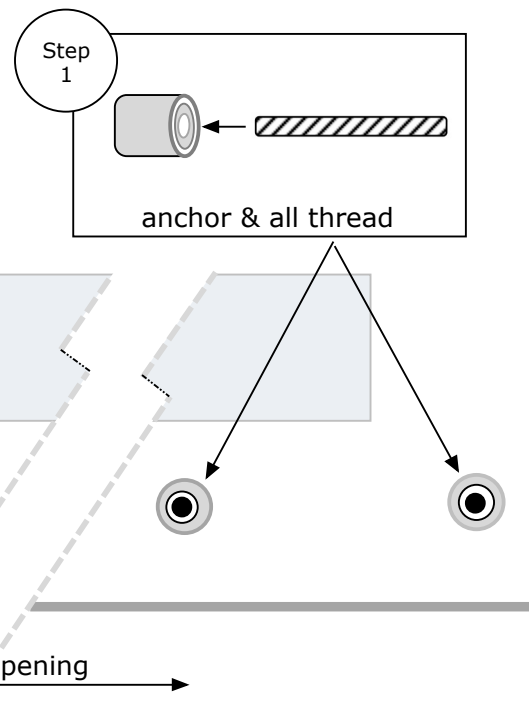

How to install End Brackets & Keepers to Direct Mount mounting systems replacing sidewalk bolts

1. Add all thread bolts to the first two lead anchors closest to outer edges of opening. All threads will replace sidewalk bolts under End Brackets.
2. Place End Brackets over all threads.
3. Slide opening of Keepers onto all threads, pushing snugly against End Bracket opening.
4. Fasten Hex nuts, lightly hand tighten
5. Repeat on opposite side of opening.

Continue with basic installation, installing storm panels as recommended by the manufacturer covering both End Brackets.

Basic Installation Corrugated Panels

Page 11

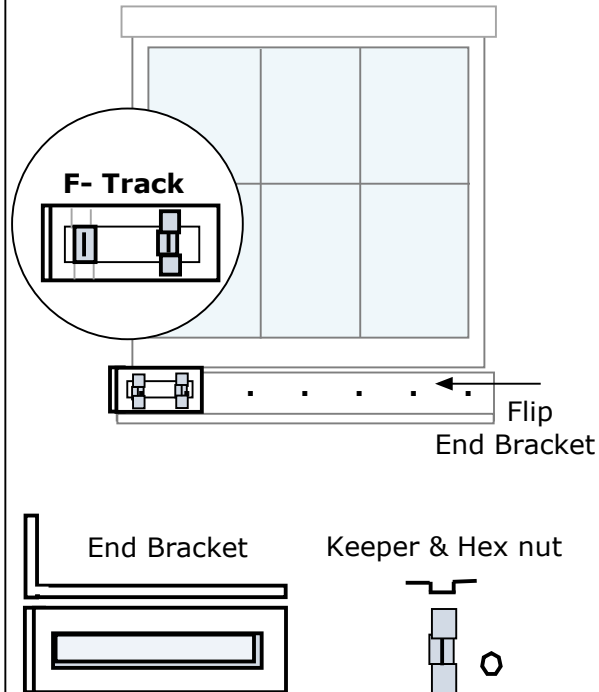

Step 1 End Brackets

Place the End bracket over mounting bolts closest to edge of opening on either end of your type of mounting system.
Cover bolts with Keepers.
For F- Track reverse first Keeper place behind End Bracket
Press Keepers snugly into End brackets.
Apply Hex nuts, lightly hand tighten.
Repeat on opposite side of opening.

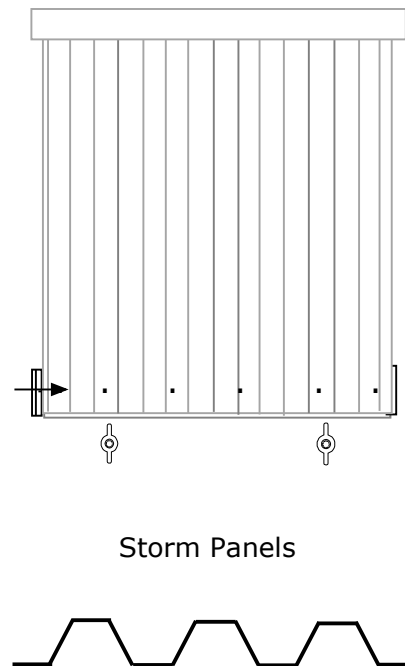

Step 2 Storm Panels

Install your panels as recommended by manufacturer.
Covering both End Brackets.
Slide End Brackets to fit against panels before tightening wing nuts.
Tighten wing nuts under Panel V Guards to a vertical position.

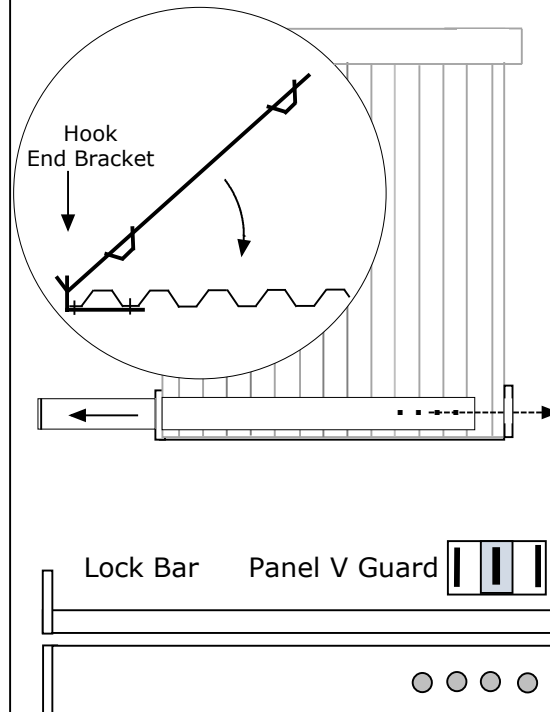

Step 3 Lock Bar

Slide at least two V Guards onto Lock Bar.
Hook Lock Bar into either End Bracket, swing Lock Bar towards panels aligning Panel V Guards to cover the wing nuts over End Brackets
slide Lock Bar back enough to push flat end through the opposite End Bracket.

Panel V Guards

Page 12

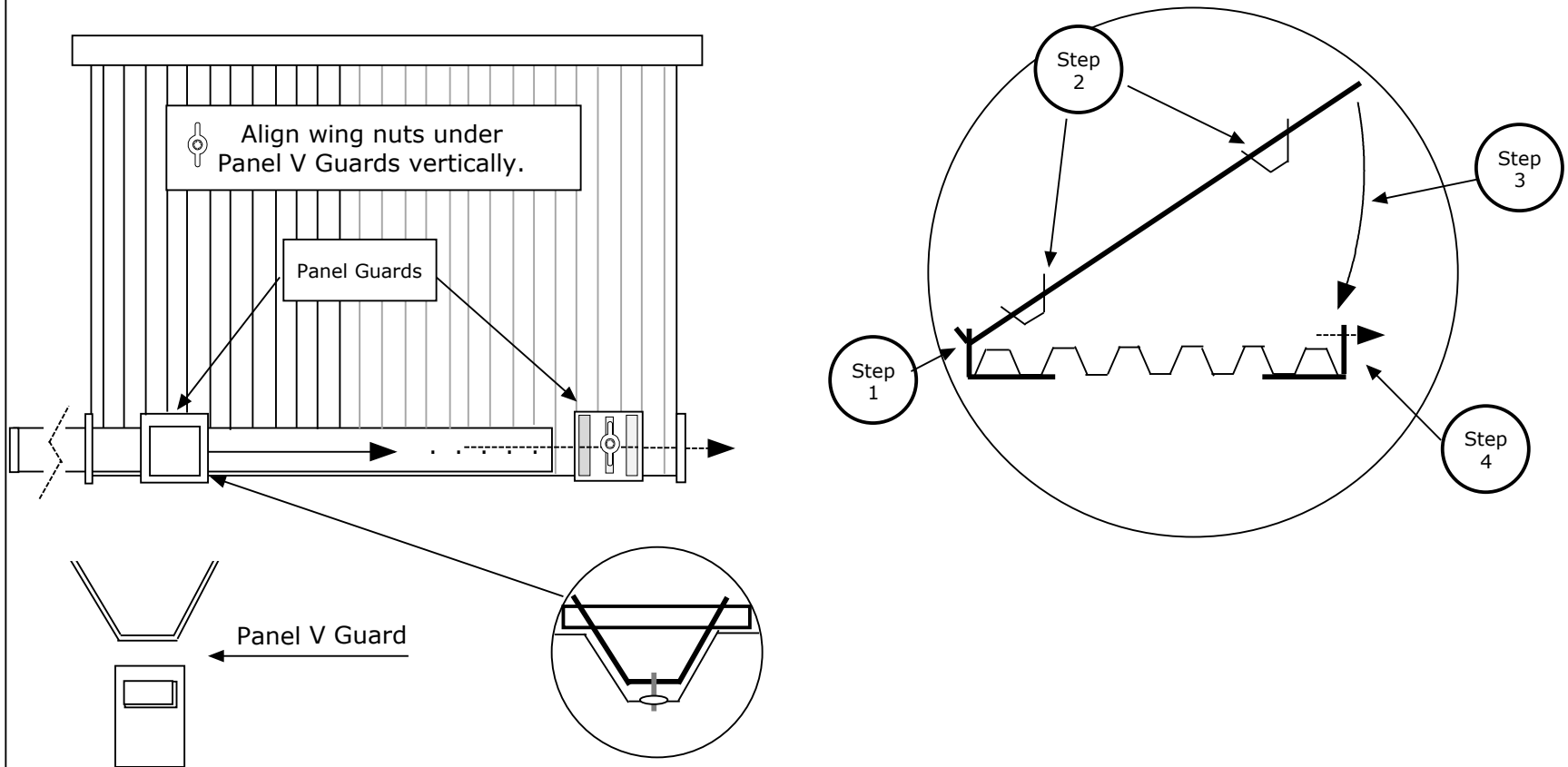

How to install Panel V Guards

1. Insert angled end of the Lock Bar into either End Bracket.
2. Slide at least two Panel V Guards onto Lock Bar.
3. Swing Lock Bar in towards storm panels aligning Panel V Guards over End Brackets wing nuts.
4. Slide Lock Bar back enough to slip flat end of the Lock Bar through End Bracket.
5. Lock.

Center Panel L Brace & Center Panel L Guard

Page 13

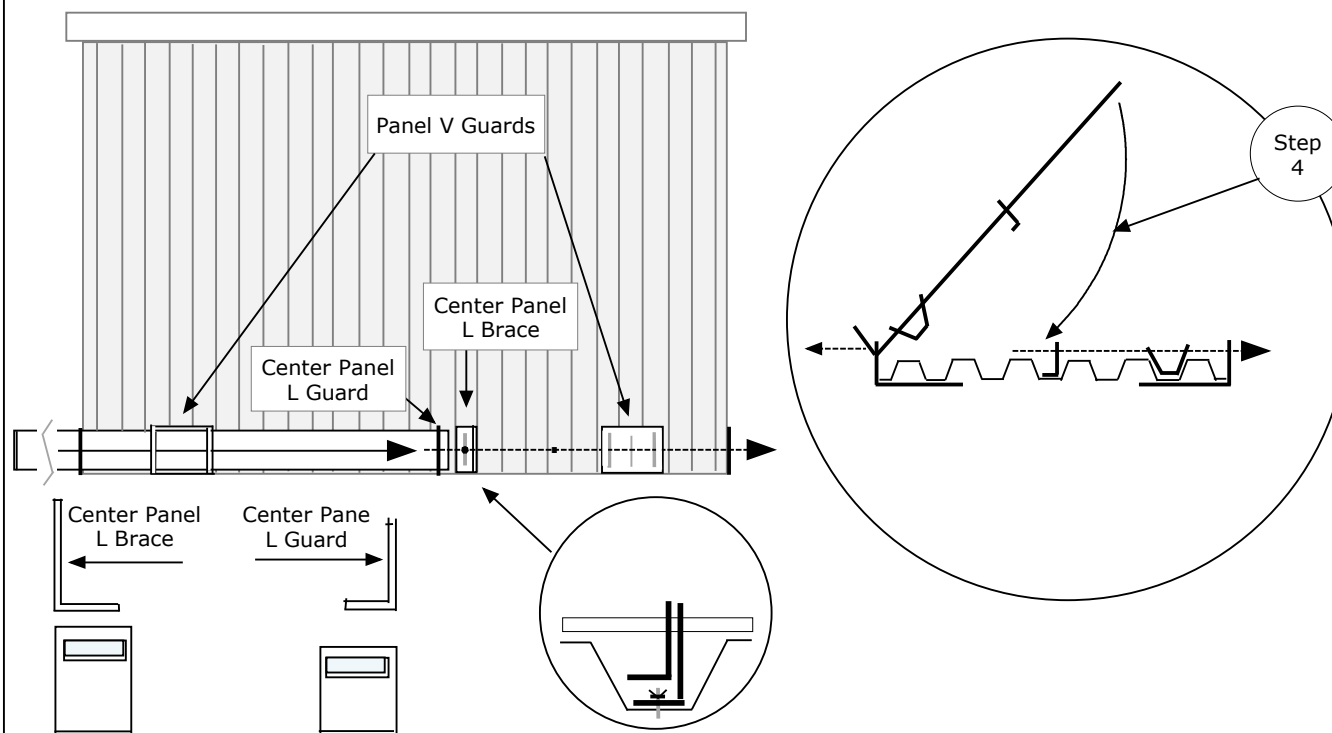

Center Panel L Brace	Center Panel L Guard	Lock Bar	Step 4
<p>Remove wing nut approximately in the center of the paneled opening.</p> <p>Place Center Panel L Brace on mounting bolt.</p> <p>Fasten wing nut.</p>	<p>Slide Center Panel L Guard on Lock Bar after first Panel V Guard.</p> <p>Align Center Panel L Guard over Center Panel L Brace.</p>	<p>Hook End Bracket with Lock Bar.</p> <p>Swing in towards storm panels,</p> <p>Panel V Guards must cover the End Brackets mounting bolts wing nuts.</p> <p>Center Panel L Guard must cover Center Panel L Brace.</p>	<p>Slide Lock Bar back enough to put flat end through Center L Brace.</p> <p>Continue to slide Lock Bar. When Lock Bar is close to the other end put Panel V Guard over End Bracket mounting bolts and wing nuts, Keep sliding Lock Bar through Panel V Guard and End Bracket.</p>

Page 14



- TOOL NEEDED

 5/32
 ALLEN WRENCH

Using Extensions

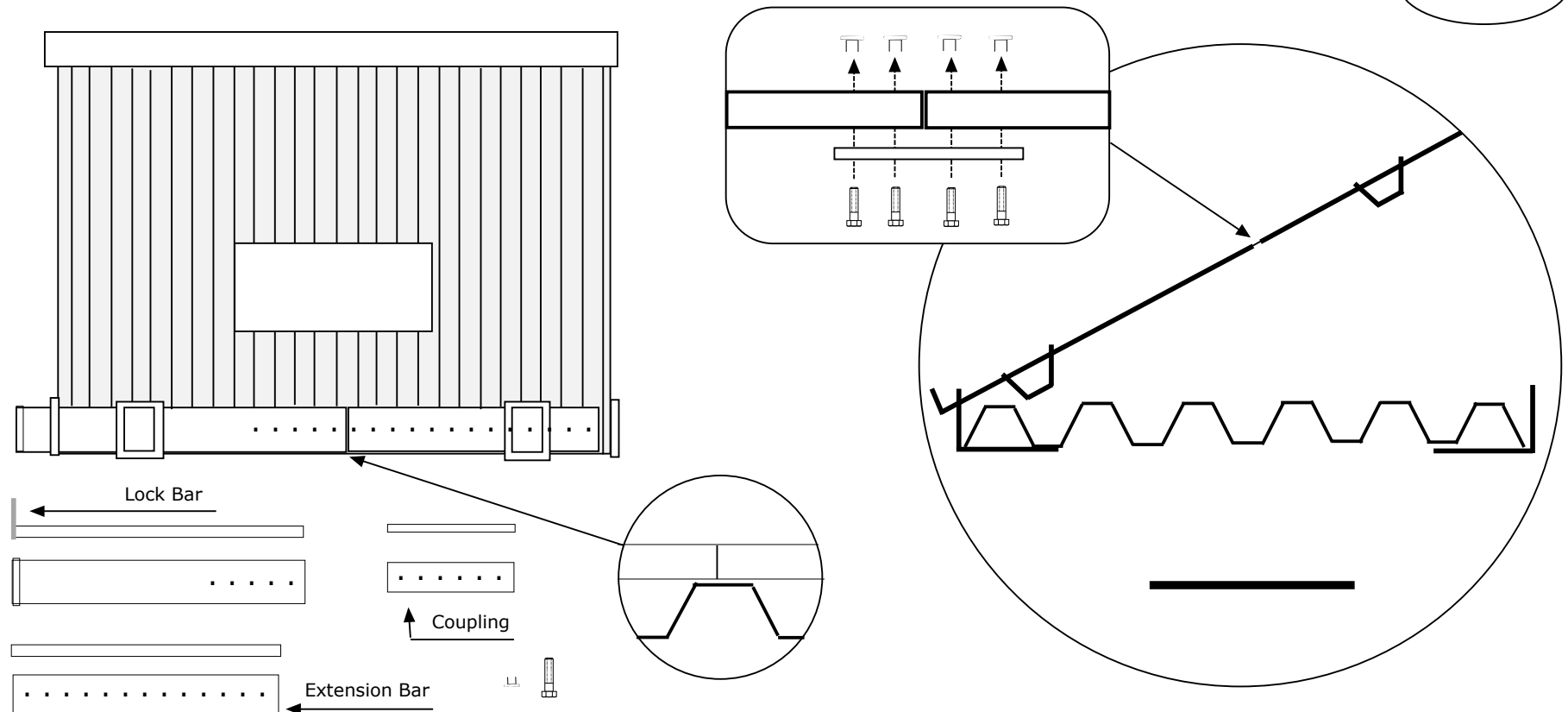
Page 15



How to add Extension Bars using Couplings

1. Align Bars to be connected.
2. Place Coupling behind Bars, matching holes in Bars to Coupling.
3. Insert Captive Nuts.
4. Thread Bolts into Captive Nuts.
5. Tighten Bolts Using Allen Wrench.

TOOL NEEDED

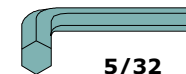

**5/32
ALLEN
WRENCH**

LOCKING

Page 16

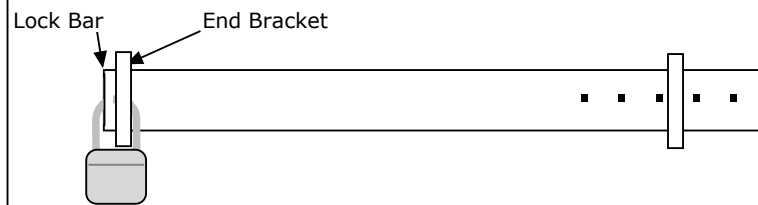
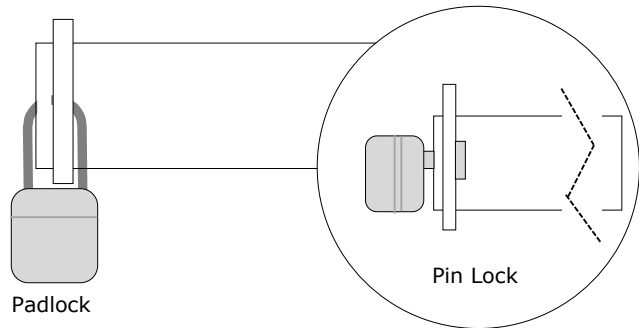

How to lock End Bracket to Lock Bar

1. Slide Lock Bar against End Bracket.
2. Place lock through holes.
3. Lock.

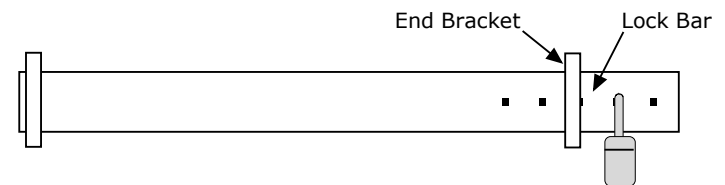
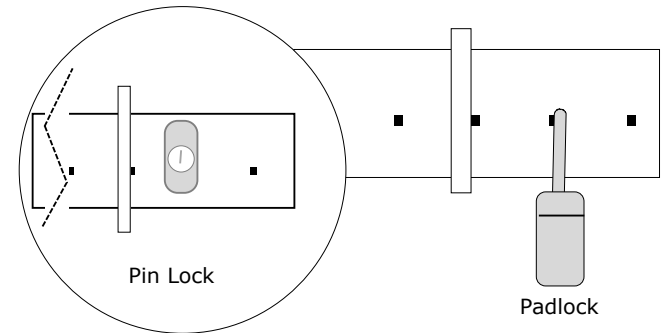

How to lock Bars separately

1. Place lock through hole past End Bracket.
2. Lock.